

SPIRAL I I-71 SB
P.I. STA. 18+984.523
 $\Delta = 72^\circ 41' 42''$ RT
R = 349.277 m
 $L_s = 118.896$ m
 $\theta_s = 9^\circ 45' 07''$
LT = 79.385 m
ST = 39.742 m
 $L_c = 324.256$ m
 $T_s = 317.646$ m
 $E_s = 86.464$ m
 $e_{max} = 0.083$
T.S. STA. 18+666.876
S.C. STA. 18+785.773
C.S. STA. 19+110.028
S.T. STA. 19+228.924

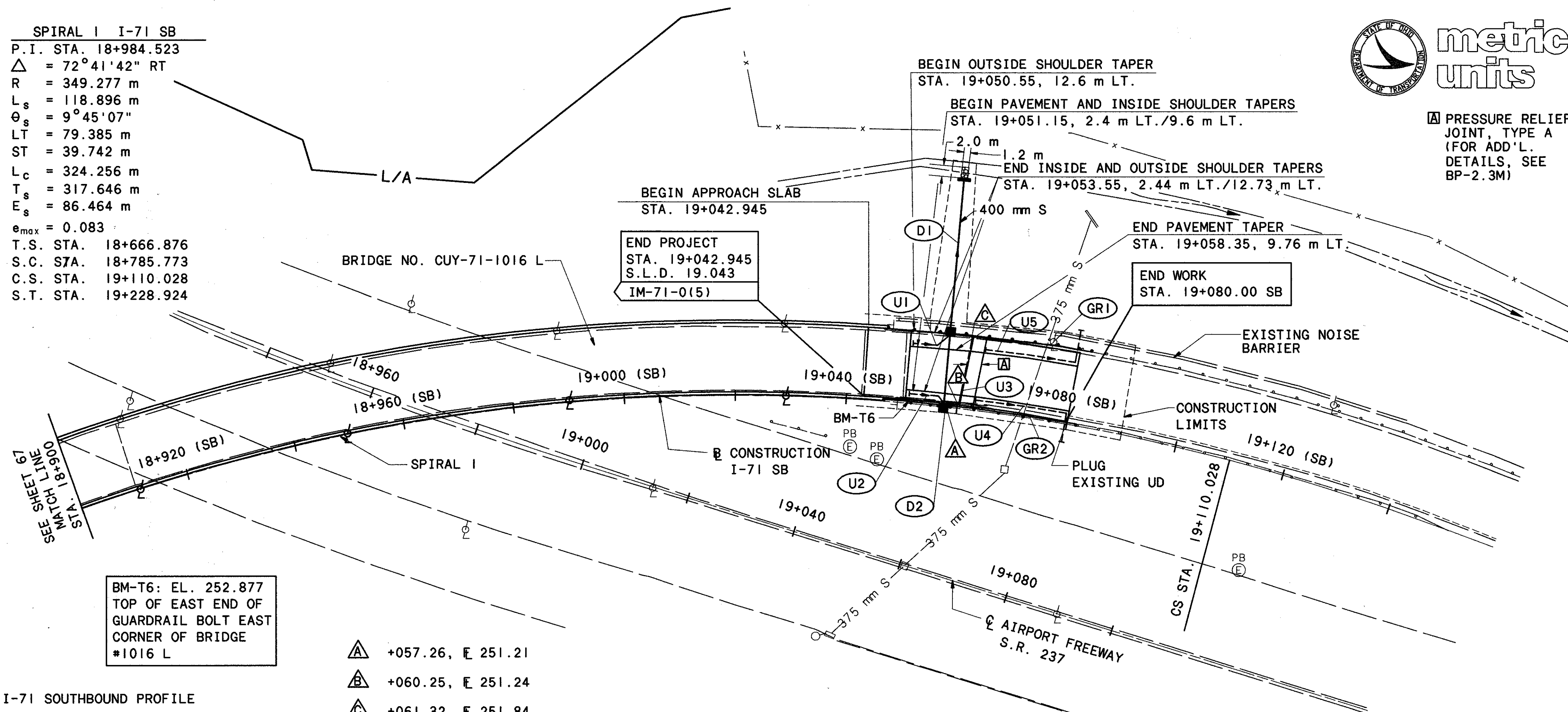

REF NO.	STATION		SPEC	605	605	100 mm FITTINGS		
	FROM	TO				BEND	TEE	WYE
U1	19+050.65	19+057.26	SB	3.00	3.61	I		
U2	19+050.65	19+057.26	SB	3.00	3.61	I		
U3	19+057.26	19+061.32	SB	3.00	12.84	I		
U4	19+063.13	19+080.00	SB	I	16.87	I		
U5	19+063.76	19+080.00	SB	I	16.24	I		
TOTALS CARRIED TO GENERAL SUMMARY			2	22.00	53.17			

* 707.17 NON-PERFORATED ASTM D3034, SDR 35, SS 931 OR SS 944

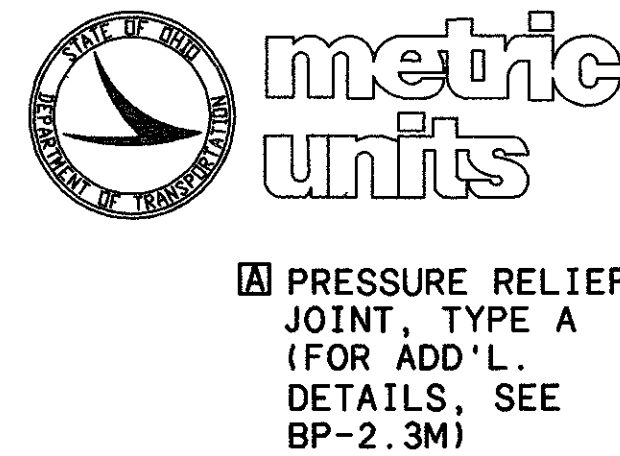
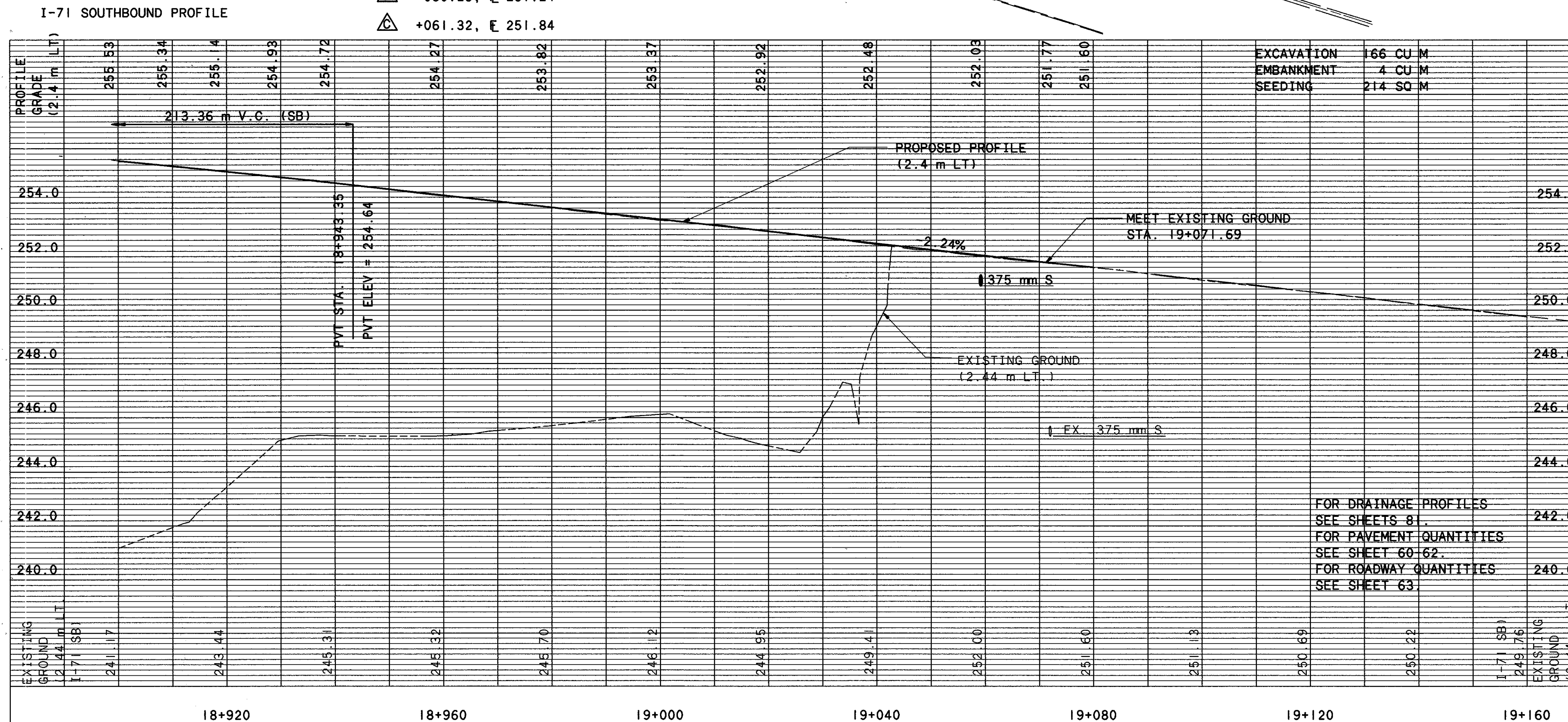

REF NO.	STATION		SPEC	605	605	100 mm FITTINGS		
	FROM	TO				BEND	TEE	WYE
D1	19+057.260	13.89 m LT.						
D2	19+057.260	0.00 m LT.						
TOTALS CARRIED TO GENERAL SUMMARY			1.2	0.25				